

Heatable Reflector for Cranes Type 8R100BLH

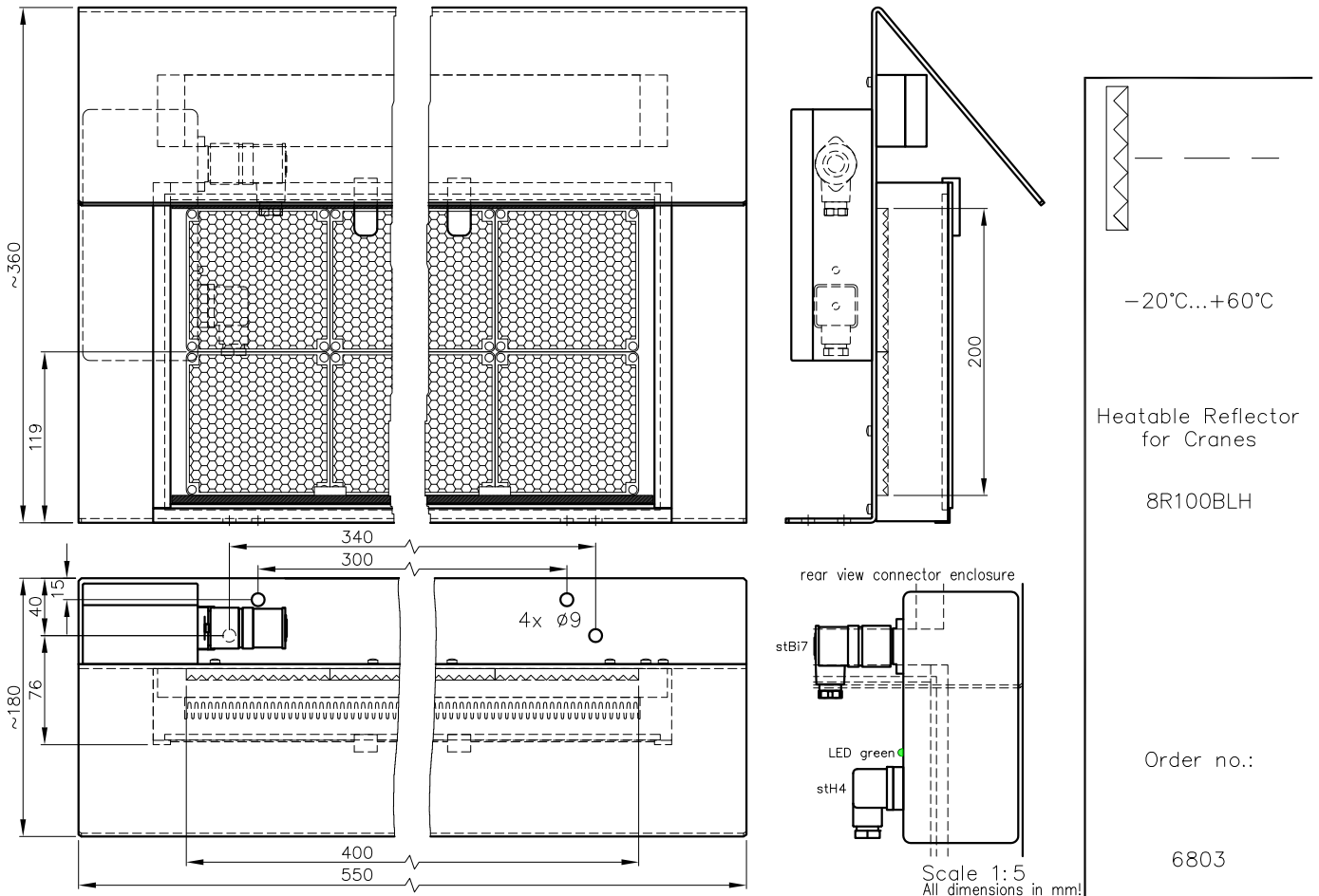

-20°C...+60°C

Heatable Reflector for Cranes

8R100BLH

Order no.:

6803

Technical Characteristics:

Housing	Steel (chromate coating), AL-cast, POM, Glass
Weight	approx. 13,5kg
Protection mode	IP65
Connection	3+1 pin plug stH4 (power supply) 6+1 pin plug stBi7 (temperature monitoring output of heatable window pane)
Power supply	24VDC/~4A
Heating power	approx. 96W
Operating indicator	LED green
Operating temperature	-20...+60°C
Permitted wind speed	Please contact the manufacturer in case of lager wind speeds

Connection diagram:

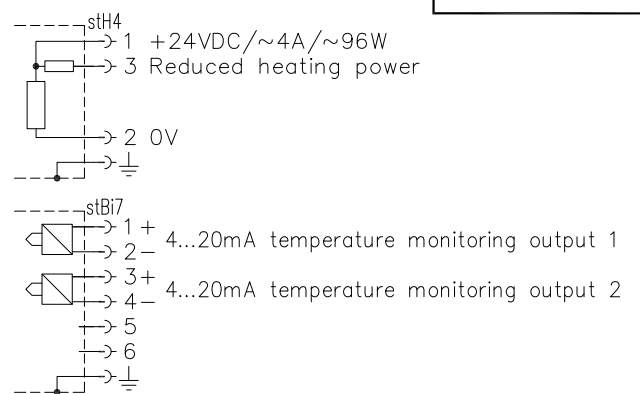

Notice:

Please refer to the manual (E_68032) for assembly and connecting instructions

Reflector fastening:

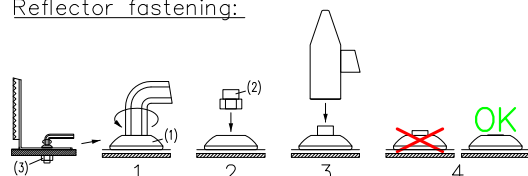

6803 DE (29.10.15 tb)
E_6803 1 (10.02.17 tb)
(10.08.12 tb) (04.09.17 tb)
(20.02.14 tb) 02.01.19 tb

Options:

Housing	Stainless steel sheet
---------	-----------------------

Accessories:

- 4x Truss-head screw (1) M8x20 DIN7380 with closing head (2)
- 4x Locknut (3) M8 DIN980