

Temperaturbeständiger Glas-Reflektor WR100x100

Heat Resistant Glass Reflector WR100x100

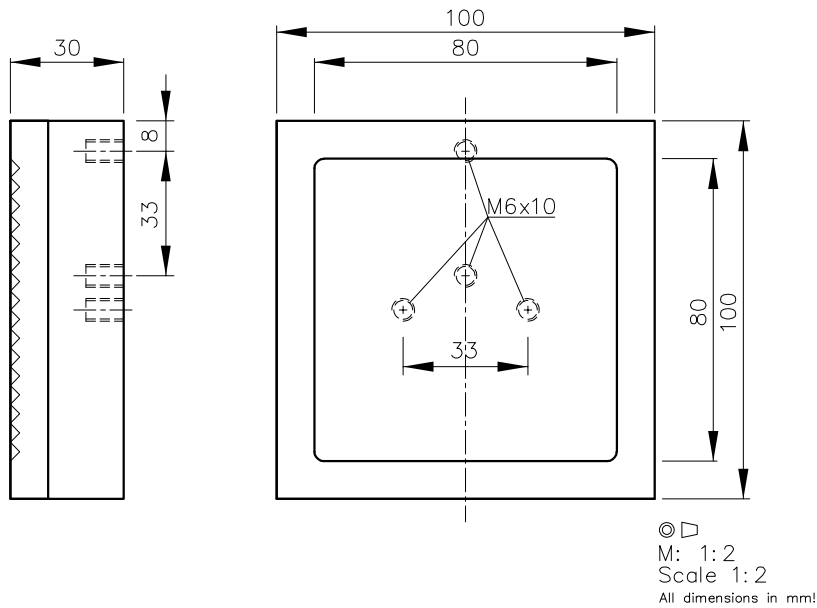

Technische Daten:

Gehäuse	Al/ Glass
Reflektionsfläche	80x80mm
Betriebstemperatur	$<200^{\circ}\text{C}</math>$

Zubehör:

Rohrkrümmerjustage Typ JR19 (1)

Technical Characteristics:

Housing	Al/ Glass
Reflecting surface	80x80mm
Ambient temperature	$<200^{\circ}\text{C}</math>$

Accessories:

Elbow Tube Adjustment Type JR19 (1)

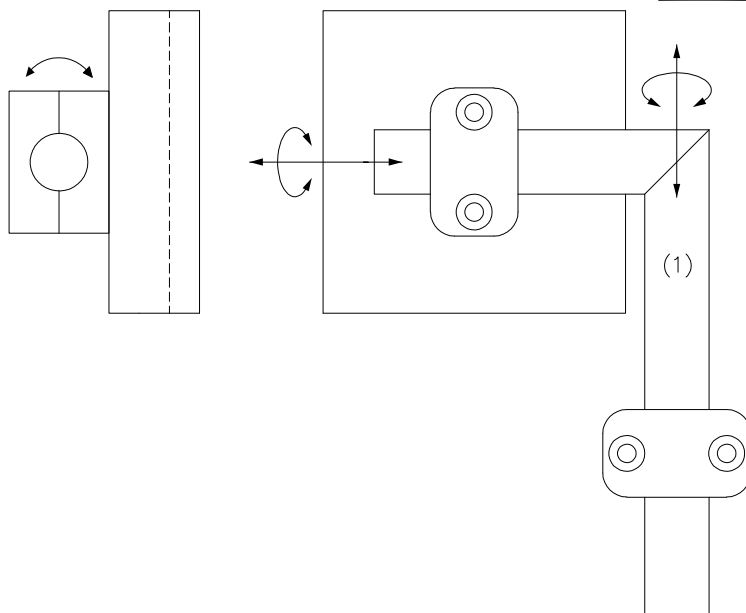

24.11.22 TBR

6426 D
D_6426_1
(19.01.98 tb)
(28.11.02)