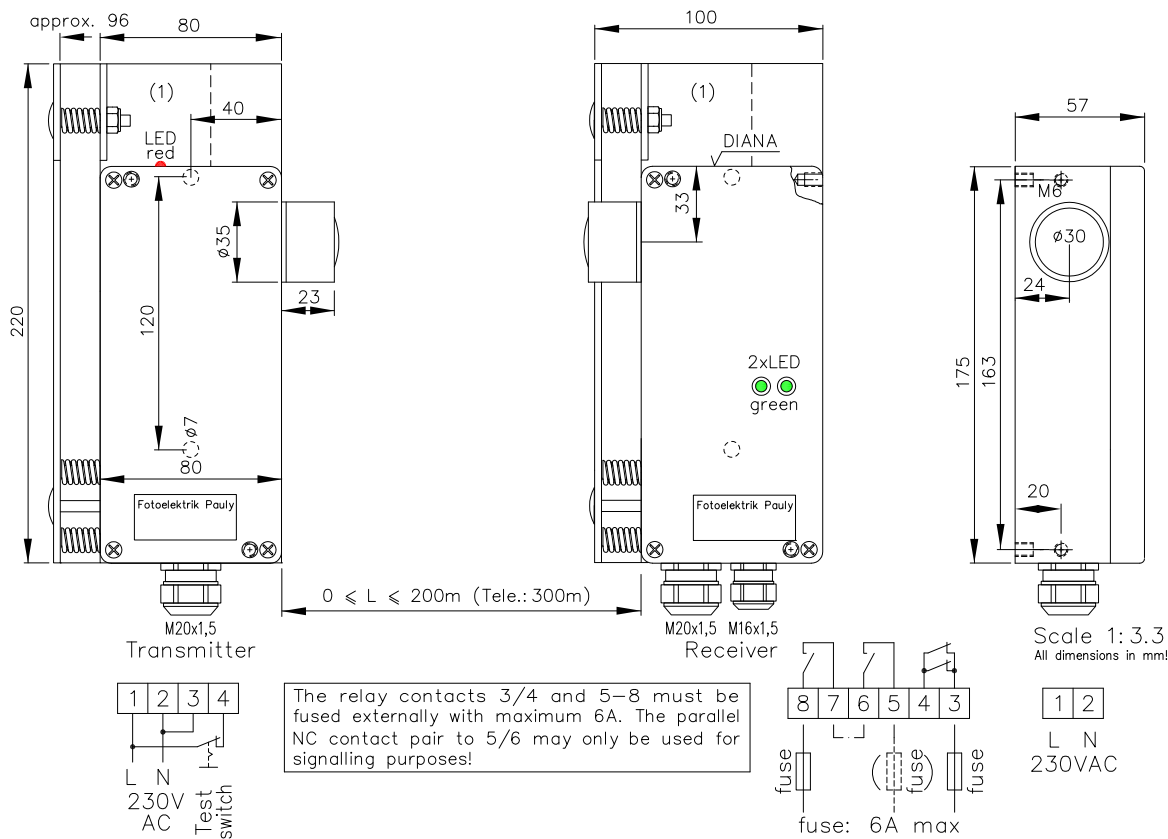
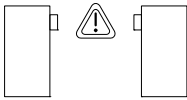

## High Range self-checking Transmitter-Receiver Light Barrier, Type PP2126/4

0...200(300m)

High Range self-checking Transmitter-Receiver Light Barrier

PP2126/4

Order no.:

5722

### Technical Characteristics:

Housing Al-Cast  
 Weight R: approx. 900g, T: approx. 700g  
 Protection mode IP66  
 Connection Terminal strip  
 Supply Transmitter: 230VAC/3VA, ±10%  
 Receiver: 230VAC/6VA, ±10%  
 Ausgang 2 Relay, 250VAC/6A  
 1300VA, supervised and forceguided, 250VAC/6A  
 Test input Optocoupler, to operating voltage  
 Signal mode brightnesswitching  
 Access time ~50ms after beam interruption  
 Transmitter light GaAs 850...880nm, invisible  
 Steady light resistance >80kLx  
 Level indicator receiver DIANA, i  
 Switch indicator receiver 2x LED green  
 Function indicator transm. LED red  
 Range 200m, with teleobjective: 300m  
 Optical reserve >500fach/20m/standardobjective  
 Active light-beam diameter standard-: ø30mm  
 teleobjective: ø50mm  
 Aperture angle standard-: T: <1,5° / R: <2,6°  
 teleobjective: T: <0,7° / R: <1,2°  
 Ambient temperatur -25...+60°C

### Special design:

Connection 6+1 pole plug stBi7  
 Supply 24VDC, 42...48VAC, 115VAC  
 Heat-protected optical system, pl  
 Teleobjective, t PP2126/4 t (<300m)  
 Dynamic cascade input

### Accessories:

Heavy adjustment flange R27SH(1)  
 Elbow tube adjustment AD27SS1 or AD27SS2  
 Cooling water flange KW27  
 Anti dust tubes TUB46  
 Deflecting mirror SP100x100  
 Diaphragms, Optical filters

### Light spot diameter:

L m	ø m	standard- objective	Tele- objective
10		<0,17	<0,1
30		<0,5	<0,25
100		<1,6	<0,8
300		(<5)	<2,5

Light spot diameter ø in relation to distance L and objective

### Teleobjective:

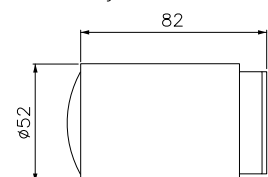

### Caution:

Two working contacts must be used always!  
 Make sure to fit a restart disabler at the machine end!

5722 DE (23.03.99 tb) (27.06.05 tb)  
 E\_5722 1 (07.01.04 gs) (27.10.10 tb)  
 (26.12.88 cm) (21.02.05 mj) 29.04.19 tb  
 (02.02.98 tb) (14.04.05 tb)