

## Transmitter-Receiver Light Barrier Types PP2110/3 & PP2109/3

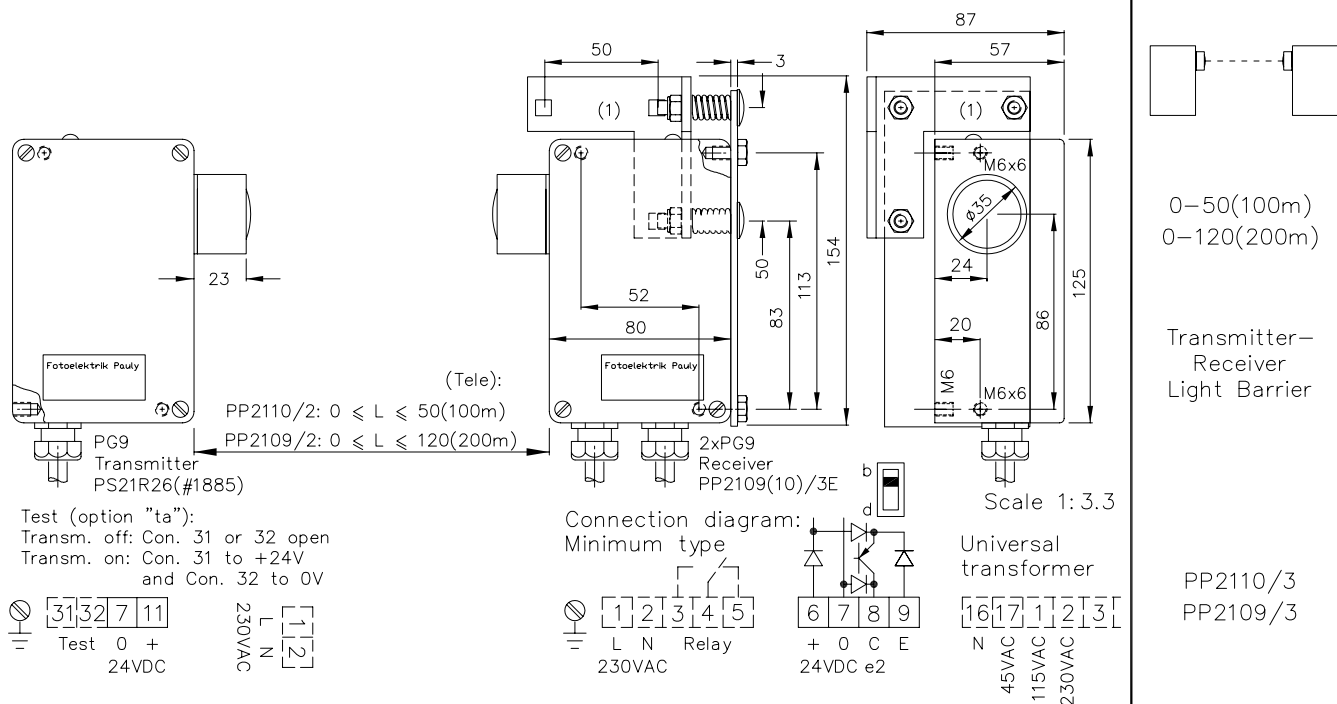

0-50(100m)  
0-120(200m)

Transmitter-Receiver  
Light Barrier

PP2110/3  
PP2109/3

Order no.:

1696  
1697

### Technical characteristics of minimum type:

Housing	Al-Cast
Weight	Receiver: approx. 700g Transmitter: approx. 500g
Protection mode	IP65
Connection	Terminal strip
Supply	Receiver: 24VDC/30mA without lead Transmitter: 24VDC/40mA
Output	pnp 60mA s.c.-prot., e2
Signal mode	bright-/darkswitching, selectable
Transmitter light	GaAs 880nm, invisible
Steady light	PP2109/2: >80kLx resistance PP2110/2: >100kLx
Access time	~5ms on; <1ms off
Switching rate	electron.: >100/s; Rel.: 10/s
Switch indicator	LED, Receiver
Working indicator	LED, Transmitter
Ambient temperatur	-25...+60°C

### Features:

Connection	4 pin Plug stLU4 4+1 pin Plug stA5 6+1 pin Plug stA7 5+1 wire No.-Cable K5 2x3 wire No.-Cable 2K3
Supply	24-80VDC 230V, 110-130V, 42-48V, 24VAC or 230/115/45VAC with universal transformer
Output	Relay 250VAC/10A, 2500VA npn 60mA s.-c.-prot., e3 Optocoupler 60V/50mA, e1 if req. 2xe2 or 2xe3 or antival. e4 or e5
Time delay	0-10s, switching-on-off-delay, separatly adjustable, z10
Level indicator	DIANA, i
Teleobjectivs, t	
Heat-protected transducer system, pl	
If using cooling water flange, then milled wall, y	
PV2110 & PV2109: Pollution warning output	
PU2110 & PV2109: 'intelligent' Pollution warning output	

### Accessories:

- Diaphragms
- Optical filters
- Adjustment flange JF26H (1)
- Heavy adjustment flange R26SH
- Elbow tube adjustment AD26SS1 or AD26SS2
- Cooling water flange KW26
- Anti dust tube TUB46
- Integrated protecion system KJT.. or KRT26\*

\* Including: cooling by water, adjustment, anti dust tube (optional: diaphragms, optical filter)

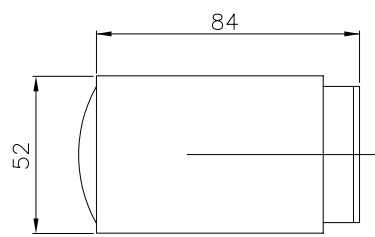

Teleobjectiv, Scale 1:2.5

1696 DE (17.02.05 m.j)  
E\_1696\_1 (10.11.98 tb)  
(09.01.03 9s)