

Contrast Measuring Device Type TRIV140220*01

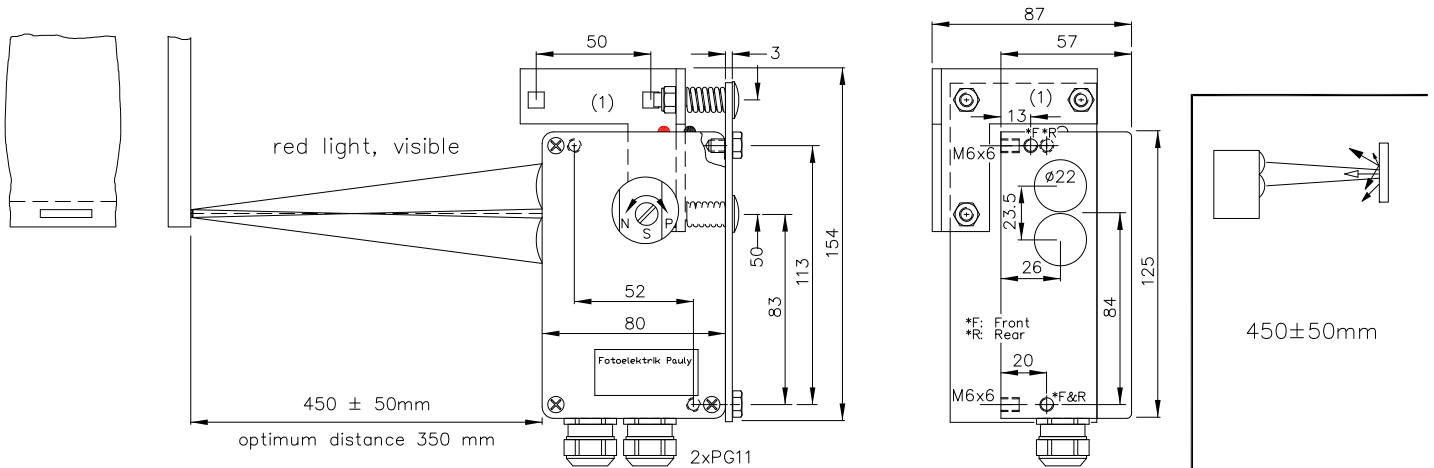

Brief instructions for operating the sensor:

1. Mount the unit in relation to the mark as shown in the drawing.
2. Let the optical system view the dark background.
3. Set the regulating screw S in such a way that one or two LED's on DIANA N light up.
4. Move the lighter background in front of the optical element and make sure that at least two or more DIANA P LED's light up. If this is not possible in rare cases (very low contrast), the contrast cannot be recognised.

General notes:

Alterations of distance as well as contamination on the optical elements will affect the system settings.* Contamination on the optically sensitive areas may cause the system to malfunction if weak contrasts have been set.* If the red and green LED's light up simultaneously, then the usable signal only has a two- to threefold reserve, this contamination warning signal can be evaluated at the "VK" control output. Applying voltage to the "test" input switches the transmitter off. The AK transistor can be bridged to terminal 3 with the "AK-Output" switch. The "AK" switch alters the switching mode from bright to dark triggering.

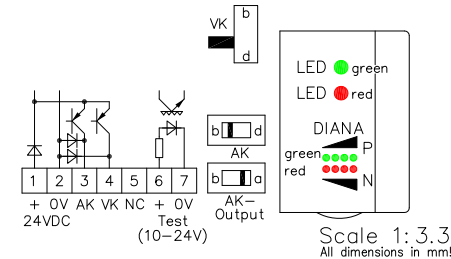

"DIANA": (Digital ANAlog indicator)
 Poti V: Receiver Amplification
 AK-Output: b: bridged, a: active
 AK, VK: b: bright-, d: dark-triggering
 S: reference screw

450±50mm
 Contrast measuring device
 TRIV140220*01
 Order no.:
 4694M01

Technical Characteristics:

Housing	Al-cast
Weight	approx. 650g
Protection mode	IP65
Connection:	Terminal strip/ PG11
Power supply	24VDC/60mA without load
Control output	pnp 60mA, s.c.-prot e2
Mode of operation	internal reference
Reference adjustment	Reference screw's light channel
Transmitting light	GaAs 650nm, visible, rl
Constant light resistance	>80kLx
Interference suppression	forced synchronisation
Access time	<12ms/switch transition
Switching rate	~40/s
Switch indicator VK/AK	LED red/green
Level indicator	DIANA P & DIANA N
Ambient temperature	-25...+60°C

Features:

Special versions:	"q": <2ms/ switch transition
Switching rate	"q": ~300/s
Sendelicht	GaAs 880nm, invisible, ir

Applications:

- Paper break monitoring on drying screen
- Recognition of printed marks

Accessories:

- Adjustment flange JF26H (1)
- Heavy adjustment flange R26SH
- Elbow tube adjustment AD26SS1 or AD26SS2
- Cooling water flange KW26
- Anti-dust tube TUB75 incl. adapter
- Diaphragms
- Special filters

The keys:

- T: Diffuse-Reflective sensor
- R: Reference mode
- I: Internal Ref.
- 14: Housing R26
- O: Optical element Lens Ø22mm
- 2: Number of optical elements
- 1: Type of transmitter & receiver
- 0: no additional control unit

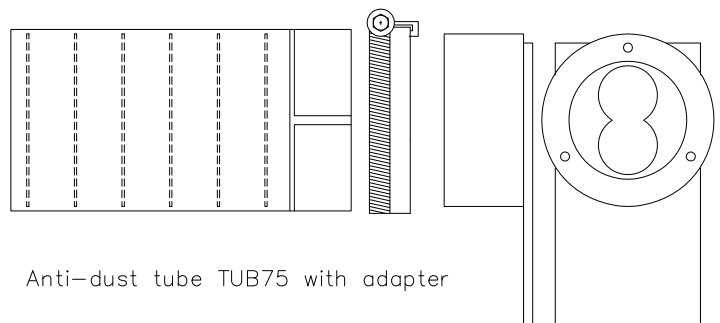

Anti-dust tube TUB75 with adapter

4694M01 DE (28.03.07 tb)
 E_4694 1 1 (08.05.14 tb)
 (18.09.02 gs) 14.05.14 tb
 (18.02.05 m)