

## Temperaturbeständiger Glas-Reflektor WR100x100

### Heat Resistant Glass Reflector WR100x100

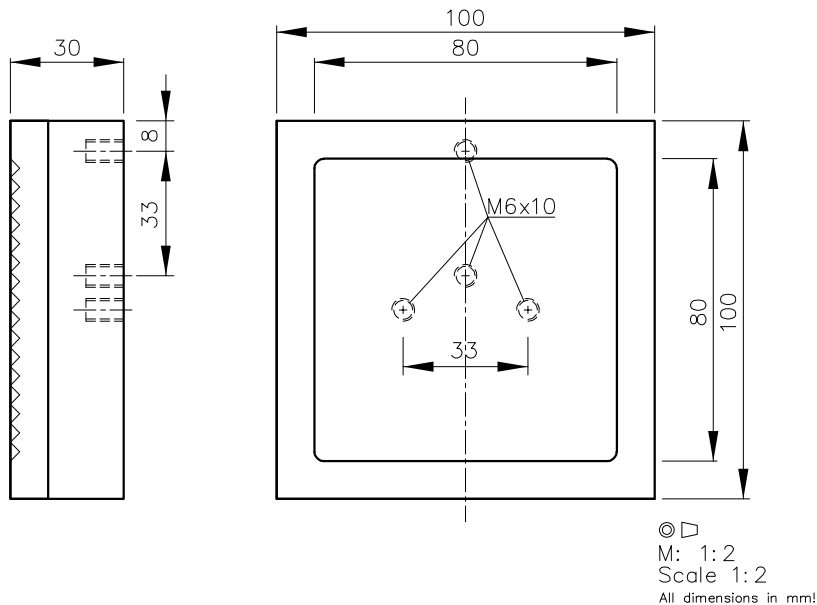

#### Technische Daten:

Gehäuse	Al/ Glass
Reflektionsfläche	80x80mm
Betriebstemperatur	<math><200^{\circ}\text{C}</math>

#### Zubehör:

Rohrkrümmerjustage Typ JR19 (1)

#### Technical Characteristics:

Housing	Al/ Glass
Reflecting surface	80x80mm
Ambient temperature	<math><200^{\circ}\text{C}</math>

#### Accessories:

Elbow Tube Adjustment Type JR19 (1)

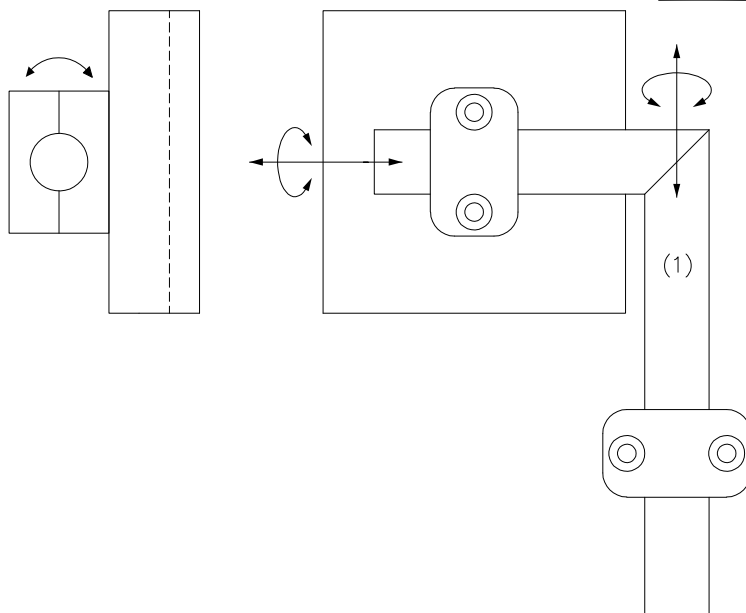

24.11.22 TBR

6426 D

D\_6426 1  
(19.01.98 tb)  
(28.11.02)